

RoHS Compliant

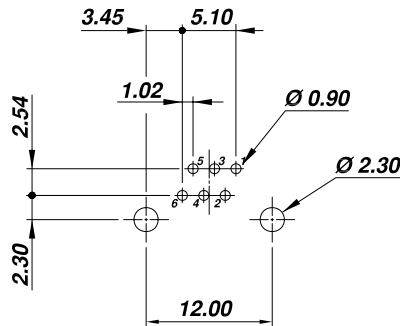
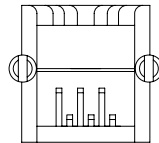
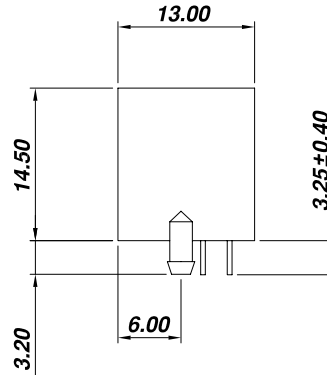
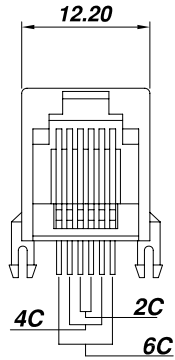

PCB LAYOUT
(Top View)

SPECIFICATION :

1. Electrical Char.

- Insulation Resistance : 500M-Ohm Min.
- Contact Resistance : 20milli-Ohm Max.
- Rating Current : 1.5A Max.
- Rating Voltage : 120V AC.
- Dielectric Voltage : 1,000 Vrms 60 Sec. Min.

2. Physical char.

- Housing (Option) :
 - PBT Glass Filled (UL 94V-0), Soldering Temperature:235°C
 - Nylon (UL 94V-0), Soldering Temperature:260°C
- Color : Black / Medium Gray Color
- Spring Wire:
 - 0.45mm Dia. Phosphor bronze Gold Plating Over Nickel
 - Temperature Range : - 40°C / +85°C
 - Durability : 500 Mating cycles Min.

AJ-026-6-X-XX-XX

B=6p2c, C=6p4c
D=6p6c

Color BK=Black
GY=Medium Gray

L=PBT Glass Filled
R=Nylon

Gold plated 1=15u, 3=50u
2=30u, 4= 6 u

ALLSUN CORPORATION

9FL,NO.292 SEC.7 CHENG TEH ROAD.TAIPEI TAIWAN.
E - mail Address : allsun @ globalsources. com

TITLE

Mini Low Profile PCB Jack
UL & cUL FILE NO. E131820

MODULAR JACKS ASSY FOR
AJ-026-6-X-XX-XX

SCALE SIZE DWG. NO. 9612 SERIES

DWG. NO.

AST026003-1

NOT SCALED DRAWING	TOLERANCE UNLESS OTHERWISE NOTICE	INCH	MM	DR.	DATE
 THIRD ANGLE PROJECTION	LINEAR	MM INCH	.00±0.01 .000±0.005 .0000±0.002	Steven CK'D	JUL-01 '08
	ANGLE +0°30'	RADIL	+0.45 -0.15	Johnn APP'D	JUL-01 '08
MM INCH				Billy	JUL-01 '08